

7. Conjunction Diagram

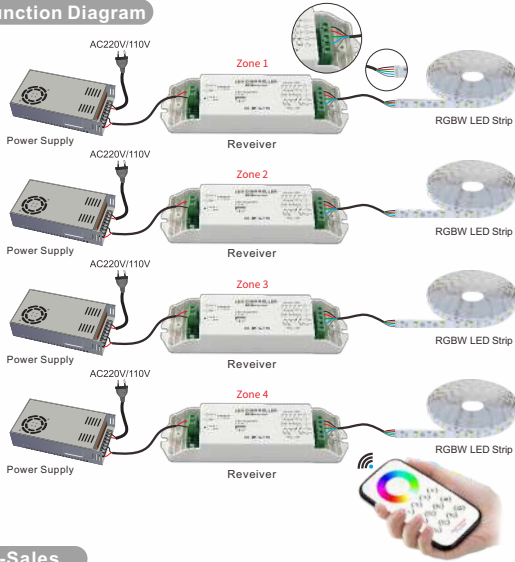

8. After-Sales

From the day you purchase our products within 3 years, if being used properly in accordance with the instruction, and quality problems occur, we provide free repair or replacement services except the following cases:

- 1.Any defects caused by wrong operations.
- 2.Any damages caused by inappropriate power supply or abnormal voltage.
- 3.Any damages caused by unauthorized removal, maintenance, modifying circuit, incorrect connections and replacing chips.
- 4.Any damages due to transportation, breaking, flooded water after the purchase.
- 5.Any damages caused by earthquake, fire, flood, lightning strike etc force majeure of natural disasters.
- 6.Any damages caused by negligence, inappropriate storing at high temperature and humidity environment or near harmful chemicals.
- 7.Product has been updated.

9. Kindly Reminder

**Power Source Selection**  
Power source must be DC constant voltage type of power supply. Due to the efficient output in some power supplies are only 80% of total, so please select at least 20% higher output power supply than the consumption of LED lights.

LED Wireless RF Remote Controller User Manual



CE FC RoHS (FCC ID: 2APBAT1)  
(Please read through this manual carefully before use)  
Update Time: 2019.05.05

1. Brief Introduction

Welcome to use this LED Controller series, This T Series Wireless remote is dedicated to controlling led lamps by RF radio frequency; there are several functions on the remote, such as on-off, modes changing, brightness and speed adjustment etc; the wireless signal is with strong penetrating power, no limit to direction or obstacles. With our R Series Receiver, it is easy to change lamp lights such as: dimming, color temperature, RGB etc; thus can satisfy the different demands of clients. T series have a simple fashion design, comfortable hand feeling, and user friendly.

2. Specifications

Model	Wireless Remote ( T6/T7/T8 )
Working Voltage	3V(CR2032)
Working Frequency	433.92MHz
Remote Distance	30m
Working Temp	-20°C-55°C
Dimensions	L106×W56×H9(mm)
Weight(N.W.)	40g

Model	Receiver ( R4M )
Compatible Remote	T6/T7/T8
Working Voltage	DC12V-DC24V
Output Current	Max 5A×4CH
Output Power	Max 240W(12V)/480W(24V)
Working Temp	-30°C-55°C
Dimensions	L176×W46×H30(mm)
Weight(N.W.)	110g

3. Basic Features

- 1.Automatically adapt to LED light which works from DC12V-24V.
- 2.The receiver can implement features such as dimming, RGB and color temperature control.
- 3.Using RF remote control, the wireless signal is with strong penetrating power, no limited to direction or obstacles, and can control the multi function of ON/OFF, change mode, brightness and speed ,etc.
- 4.10 strobe & fade change mode, with 4096 grey scales per channel, led lamp is more rich and vivid without flash.

4. Safety warnings

- Please don't install this controller in lightening, intense magnetic and high-voltage fields.
- 1.reduce the risk of component damage and fire caused by short circuit, make sure correct connection.
  - 2.Always be sure to mount this unit in an area that will allow proper ventilation to ensure a fitting temperature.
  - 3.Check if the voltage and power adapter suit the controller. (please select DC12-24V power supply with constant voltage)
  - 4.Don't connect cables with power on; make sure a correct connection and no short circuit checked with instrument before power on.
  - 5.Please don't open controller cover and operate if problems occur.
- The manual is only suitable for this model; any update is subject to change without prior notice.

5. Dimensions

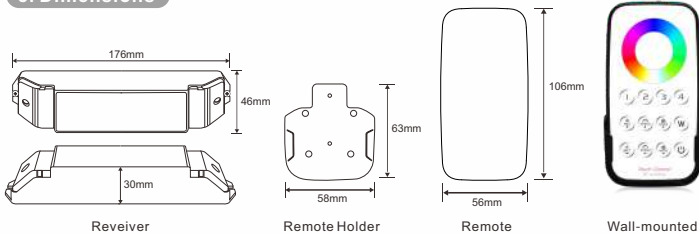

6. Operating instructions

Optional with Three Models of RF Remote:

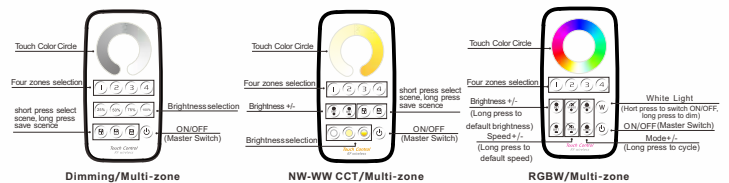

Notice: The remote control will enter dormant status without operation for 30 seconds, please press any key to reactive it.

The Learning ID Method of Remote Control:

**Learning ID:** Press ID learning button on the receiver for 3 seconds, when the running light is on, then press any key of "1", "2", "3", "4" on the remote control, the running light flashes several times, activated. Each receiver can learn 4 remote controller, but each remote control can only record the first learning zone. If you want to change the zone ID,pls delete the ID first ,and relearning.

**Cancel ID:** Press ID learning button on the receiver for 5 seconds.

RGBW remote control for changing modes:

Sequence	Modes	Description
1	3 color skipping	Red, green and blue 3-color skipping
2	7 color skipping	Red, green, blue, yellow, purple, cyan, white 7-color skipping
3	White color strobe	White (with all red, green and blue on) strobe
4	3 color smooth	Red, green and blue 3-color gradual changes
5	Full color smooth	All 7-color gradual changes
6	RG color smooth	Red, green 2-color gradual changes
7	RB color smooth	Red, blue 2-color gradual changes
8	GB color smooth	Green, blue 2-color gradual changes
9	White color fade & change	White (with red, green & blue on) gradual bright & fade
10	Great cycle	All changing modes overlap cycle