

RGB/RGBW remote control and touch panel controller changing modes:

NO	Modes	Description
1	3 color skipping	Red, green and blue 3-color skipping
2	7 color skipping	Red, green, blue, yellow, purple, cyan, white 7-color skipping
3	White color strobe	White (with all red, green and blue on) strobe
4	3 color smooth	Red, green and blue 3-color gradual changes
5	Full color smooth	All 7-color gradual changes
6	RG color smooth	Red, green 2-color gradual changes
7	RB color smooth	Red, blue 2-color gradual changes
8	GB color smooth	Green, blue 2-color gradual changes
9	White color fade & change	White (with red, green & blue on) gradual bright & fade
10	Great cycle	All changing modes overlap cycle

8. After-Sales

From the day you purchase our products within 3 years, if being used properly in accordance with the instruction, and quality problems occur, we provide free repair or replacement services except the following cases:

- 1.Any defects caused by wrong operations.
- 2.Any damages caused by inappropriate power supply or abnormal voltage.
- 3.Any damages caused by unauthorized removal, maintenance, modifying circuit, incorrect connections and replacing chips.
- 4.Any damages due to transportation, breaking, flooded water after the purchase.
- 5.Any damages caused by earthquake, fire, flood, lightning strike etc force majeure of natural disasters.
- 6.Any damages caused by negligence, inappropriate storing at high temperature and humidity environment or near harmful chemicals.
- 7.Product has been updated.

9. Kindly Reminder

Power Source Selection

Power source must be DC constant voltage type of power supply. Due to the efficient output in some power supplies are only 80% of total, so please select at least 20% higher output power supply than the consumption of LED lights.

R Series Constant Current Receiver User Manual



(Please read through this manual carefully before use)

Update Time: 2019.4.28

1. Brief Introduction

Welcome to use this R series Constant Current LED receiver ,it is workable for dimming ,color temperature,RGB and RGBW control,which can be controlled by our T series wireless remote and PX series touch panel controller. with 4096 grey scales each channel , led lamp is more rich and vivid without strobe flash . It is suitable for single color,color temperature ,RGB and RGBW LED lamp.

2. Specifications

Model	R4-CC-433M	R4-CC-2.4G
Working Voltage	DC12V-DC48V	DC12V-DC48V
Output Current	350/700mA×4CH	350/700mA×4CH
Driving LEDs/ CH	1~12pcs 1W(3W) LED	1~12pcs 1W(3W) LED
Working Temp	-30°C-55°C	-30°C-55°C
Dimensions	L176×W46×H30(mm)	L176×W46×H30(mm)
Weight(N.W.)	137g	137g

3. Basic Features

- 1.Automatically adapt to LED light which works from DC12V-48V.
- 2.The receiver can compatible with our 5 different function remote control or 2.4G wireless controller to realize function such as dimming, RGB/RGBW and color temperature control.
- 3.10 strobe&fade change mode , with 4096 grey scales per channel, led lamp is more rich and vivid without flash .

4. Safety warnings

- Please don't install this controller in lightening, intense magnetic and high-voltage fields.
- 1.reduce the risk of component damage and fire caused by short circuit, make sure correct connection.
 - 2.Always be sure to mount this unit in an area that will allow proper ventilation to ensure a fitting temperature.
 - 3.Check if the voltage and power adapter suit the controller. (please select DC12-24V power supply with constant voltage)
 - 4.Don't connect cables with power on; make sure a correct connection and no short circuit checked with instrument before power on.
 - 5.Please don't open controller cover and operate if problems occur. The manual is only suitable for this model; any update is subject to change without prior notice.

5. Dimensions

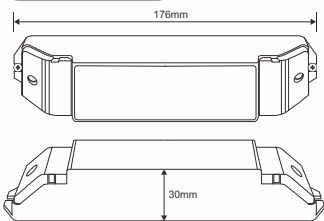

6. Receiver instruction

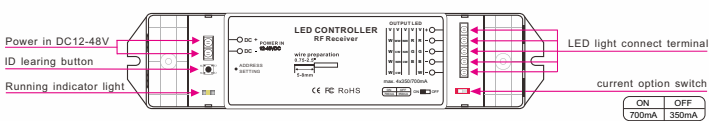

The Learning ID Method of Remote Control:

Learning ID: Press ID learning button on the receiver until the indicator light is on, then press any key on the remote control or any zone key on the touch panel , the indicator light flashes, activated.

Cancel ID: Press ID learning button on the receiver for 5 seconds.

7. Conjunction Diagram

1. R4-CC-433M work with our T series wireless remote :

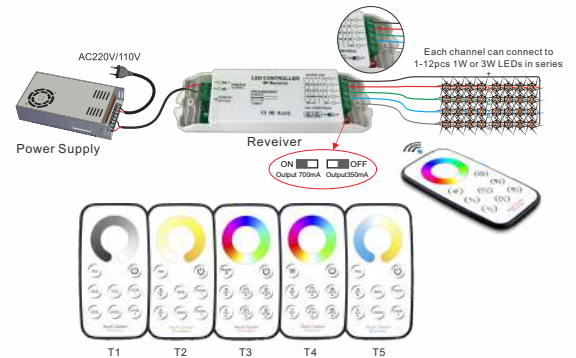

2. R4-CC-2.4G work with our PX series DMX touch panel controller :

