

PX Series touch panel

(Single-zone series)



Technical Specs:



P1X: Dim Panel

- Input Voltage: AC85V-265V
- Output Signal: DMX512+2.4G WIRELESS
- DMX512 Socket: Wiring Terminal
- Dimming Range: 5%-100%
- Working Temperature: -20°C-55°C
- Dimension: L86×W86×H36(mm)
- Weight (G. W): 230g



P2X: CCT Panel

- Input Voltage: AC85V-265V
- Output Signal: DMX512+2.4G WIRELESS
- DMX512 Socket: Wiring Terminal
- Working Temperature: -20°C-55°C
- Dimension: L86×W86×H36(mm)
- Weight (G. W): 230g



P3X: RGB Panel

- Input Voltage: AC85V-265V
- Output Signal: DMX512+2.4G WIRELESS
- DMX512 Socket: Wiring Terminal
- Working Temperature: -20°C-55°C
- Dimension: L86×W86×H36(mm)
- Weight (G. W): 230g



P4X: RGBW Panel

- Input Voltage: AC85V-265V
- Output Signal: DMX512+2.4G WIRELESS
- DMX512 Socket: Wiring Terminal
- Working Temperature: -20°C-55°C
- Dimension: L86×W86×H36(mm)
- Weight (G. W): 230g

- 1 -

Installation:

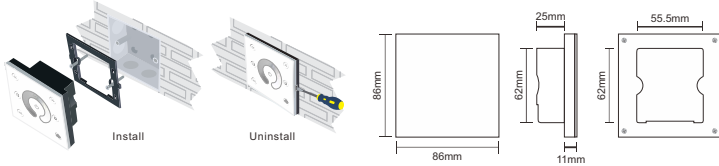

Receiver instruction:

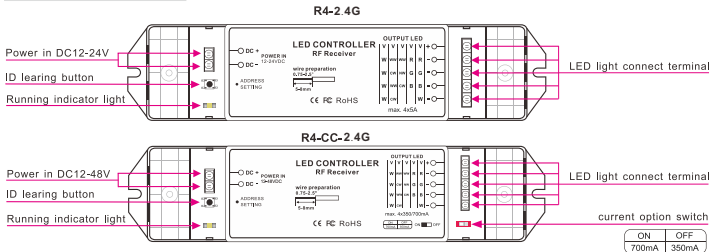

The matching method between panel and receiver :

learning ID : Press ID learning button on the receiver for 3 seconds. when the indicator light is on, press any zone key on the touch panel, the indicator light flashes (the frequency is 1Hz), activated.

Cancel ID : Press ID learning button on the receiver for 5 seconds. When the indicator light flashed quickly (the frequency is 5Hz), and all learnt IDs have been canceled.

Notice: The receiver can memorize up to 8 IDs. When receiving control information from any learnt ID, it can be controlled. If the memorized ID up to 8, long press learning key for 3 seconds to get out of the learning status, cancel the ID and reset.

- 3 -

Receiver (R4-2.4G)

- Working Voltage: DC12V-DC24V
- Output Current: Max 5A×4CH
- Output Power: Max 240W(12V)/480W(24V)
- Receiver Distance: 30M
- Working Temp: -30°C-55°C
- Dimensions: L176×W46×H30(mm)
- Weight(N.W.): 110g

Key Functions:

P1X: Dim Panel

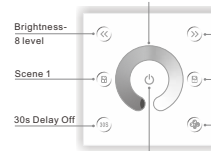

P2X: CCT Panel

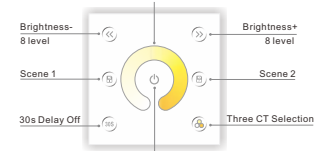

P3X: RGB Panel

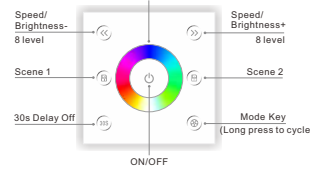

P4X: RGBW Panel

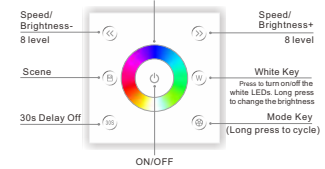

※ Long press to turn on/off the buzzer.

※ Short press to call scene, long press to save scene.

※ Hold the keys for 2 second, the controller will restore default and restart automatically.

※ P3X and P4X, short press key under static to adjustable brightness;

short press key under dynamic to adjustable speed, long press the brightness.

※ RGB & RGBW MODE:

NO.	MODE	NO.	MODE
1	RGB CHANGE	2	COLOR CHANGE
3	WHITE FLASH	4	RGB FADE
5	COLOR FADE	6	RG FADE
7	RB FADE	8	GB FADE
9	WHITE FADE	10	ALL MODE CYCLE

- 2 -

Wiring Diagram:

Take P4X connection diagram as example:

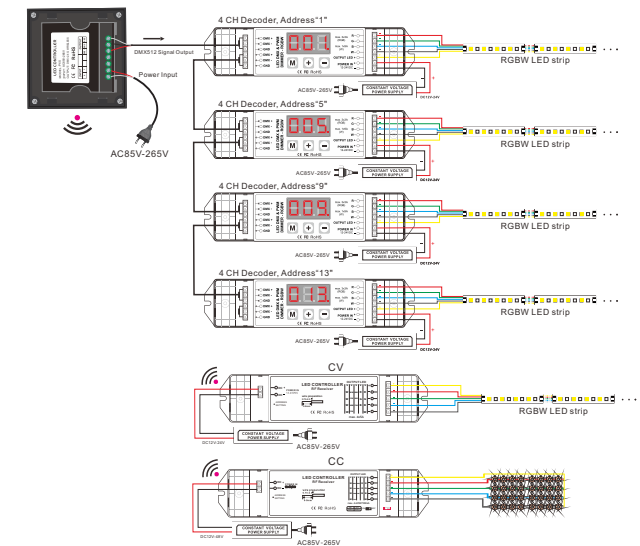

- 4 -